

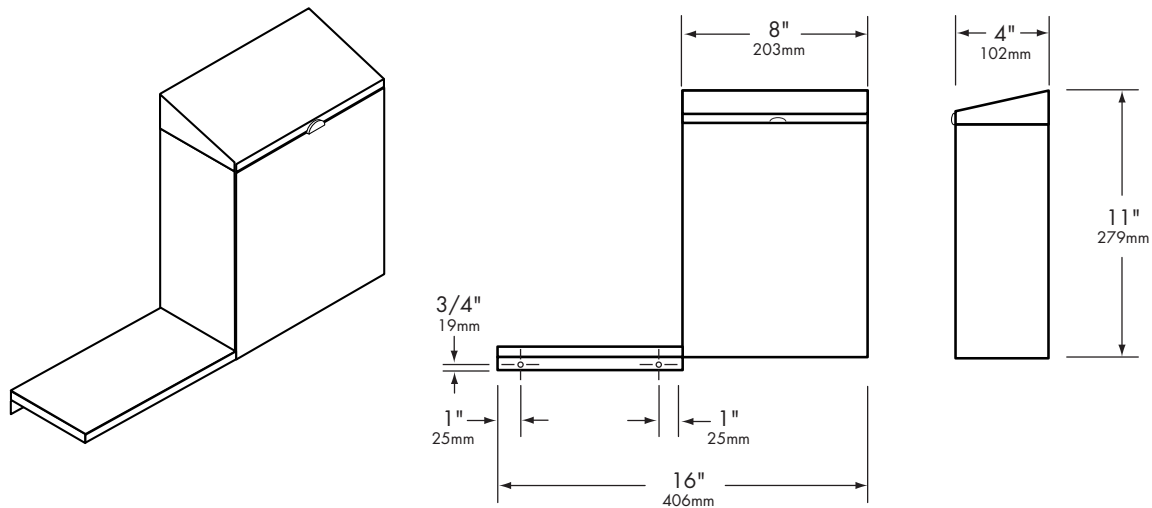

## ND-2 Surface Mounted Napkin Disposal with Shelf



### Construction:

Fabricated of 22 gauge (0.8mm) 18-8 type 304 stainless steel with exposed surfaces #4 satin finished. Doors mounted on full length stainless steel piano hinges. Top door provided with handle for easy opening, and bottom door provided with handle and dimpled catch locking device. All welded construction.

Shelf - fabricated of 18 gauge (1.2mm) 18-8 type 304 stainless steel with exposed surfaces #4 satin finished. Shelf can be mounted to either right or left hand side.

### Overall Dimensions:

16" (406mm)W x 11" (279mm)H x 4" (102mm)D

### Options:

ND-1E same as ND-1 (no shelf) except all 26 gauge (0.4mm) stainless steel for economy use  
ND-1W same as ND-1 (no shelf) except in white  
ND-2W same as ND-2 except in white

*Manufacturer reserves the right to make changes in design or dimensions without formal notice.*