

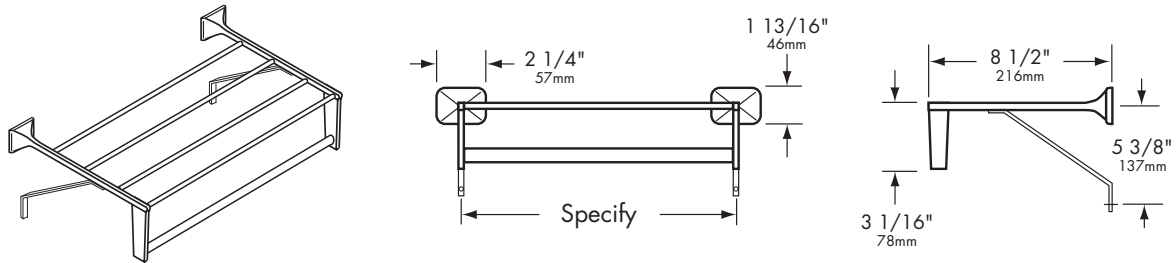

1474 Towel Shelf



Construction:

Towel shelf posts and extension towel bar posts are die cast from highest quality virgin zinc alloy (Zamak) to meet ASTM standard B-86. Castings are highly polished and chrome plated. Wallplates are 19 gauge (1.1 mm) type 304 stainless steel. Crossbars are $5/16$ " (8mm) round light type 304 stainless steel. Extension towel bar is $5/16$ " (8mm) round light type 304 stainless steel. Braces are $3/8$ " (9mm) chrome plated brass.

Installation:

Mount wall plates (or wall plates on aluminum plates) at $17\text{-}7/8$ " (454mm) C-C for 18" (457mm) shelf with bar and $23\text{-}7/8$ " (606mm) C-C for 24" (610mm) shelf with bar on wall surface in horizontal position with 4- #8 x $1\text{-}1/4$ " (32mm) roundhead zinc plated steel screws provided or 4- #6/32 x 3" (76mm) zinc plated steel truss head toggle bolts provided. Slip pre-assembled towel shelf with bar over wall plates and tighten set screws until heads are flush and secure on projecting posts. Mount braces to shelf posts with 2- #8/32 x $5/16$ " (8mm) flathead zinc plated steel machine screws provided (wide angle sides of braces must be mounted to projecting posts). Mount opposite sides of braces to wall with 2- #8 x $1\text{-}1/4$ " (6mm) roundhead zinc plated steel screws provided. Wood blocking is preferable behind all wall surfaces.

Note:

If wood blocking is not available, the following optional fasteners are suggested:

Tile/Masonry - Lead anchors

Plaster/Drywall - Toggle bolts

Manufacturer reserves the right to make changes in design or dimensions without formal notice.